 ITI LIMITED (A Government of India Undertaking)		Phone	080-28503614	
		e mail & Website	imm_bgp@itilttd.co.in & pnchaudhary_bgp@itilttd.co.in www.itilttd.in	
BANGALORE PLANT				
DOORAVANI NAGAR BANGALORE- 560016				
ENQUIRY				
		Enquiry Ref No.	M3526G001	
		Enquiry Date	20.09.2025	
		Due Date & Time	27.09.2025, 4.00 PM	
Please quote best prices for the item as mentioned below.				
ITEM Sl No.	ITEM CODE	DESCRIPTION	Make	QTY
1	DD6D6000005NSA2	DOME HEAD BLIND BULB RIVET, SEMI STRUCTURAL, STEEL ZN PLATED BODY, STEEL ZN PLATED MANDREL, SIZE: 4x10, GRIP RANGE 3-5mm Refer: Drawing attached	1. AVLOCK INTERNATIONAL INDIA.PVT. LTD 2. HORIZON INC. 3. INNOVATIVE SYSTEMS 4. JC GUPTA & SONS 5. LPS BOSSARD PVT. LTD. 6. MVD Fasteners 7. ROYAL INDUSTRIAL SUPPLIERS	27000
2	DD6D6000007NSA2	DOME HEAD BLIND BULB RIVET, SEMI STRUCTURAL, STEEL ZN PLATED BODY AND MANDREL, SIZE: 4.8x14, GRIP RANGE 6 TO 8.5mm Refer: Drawing attached	1. AVLOCK INTERNATIONAL INDIA.PVT. LTD 2. HORIZON INC. 3. INNOVATIVE SYSTEMS 4. JC GUPTA & SONS 5. LPS BOSSARD PVT. LTD. 6. MVD Fasteners 7. ROYAL INDUSTRIAL SUPPLIERS	9000
3	DD6D6000009NSA2	POP RIVET, STEEL ZN PLATED BODY, STEEL ZN PLATED MANDREL, SIZE: 3.2 x 8, GRIP RANGE 1.5 to 3.2 mm Refer: Drawing attached	1. EXCEL TRADING CORPORAION 2. HORIZON INC. 3. INNOVATIVE SYSTEMS 4. JC GUPTA & SONS 5. VARIO ENGINEERING SOLUTIONS 6. MVD Fasteners 7. ROYAL INDUSTRIAL SUPPLIERS	20000
4	DD6C9010003SNS	CLINCH STUD SELF FINISHING FOR 1.6mm SHEET, SS304, LENGTH:20mm, DIA:8.2mm, THREAD:M6, M6x20 Refer: Drawing attached	1. OSCAR FASTENER 2.UNIQUE ENTERPRISERS 3. INNOVATIVE SYSTEMS 4. JC GUPTA & SONS 5. MVD Fasteners 6. ROYAL INDUSTRIAL SUPPLIERS	1200
1. Kindly submit separate Technical Bid and Finance Bid in sealed cover. 2. Please attach MSME certificate if applicable. 3. Bids shall be evaluated FOR ITI bangalore 4. Sample has to be submitted for technical evaluation if required.				
If any further details/clarifications required towards submission of offer, please contact Mr.P N Chaudhary, DGM-IMM email: pnchaudhary_bgp@itilttd.co.in or imm_bgp@itilttd.co.in.				
NOTE	1	Delivery location: FOR ITI Limited Bangalore.		
	2	Payment term: 100% after delivery against the invoice submitted with 60 days credit /Or LC 60 days credit (Note: Incase of LC Payment Vendor has to bear the LC Opening charges)		
	3	Delivery period: Within 2 week from the date of PO.		
	4	LD Clause: A sum equivalent to ½% (half percent) per week for first four weeks and 0.7% per week thereafter for such delay or part thereof or terminate the contract in respect of the balance supply so delayed and purchase materials elsewhere at the risk and cost of the defaulting supplier. (LD is capped at 12% of the PO Value) .		
	5	Warranty clause (if applicable) shall be mentioned in the bid.		
	6	COC, test reports, and all relevant documents pertaining to this order must be submitted along with the supply for inspection clearance		
	7	Quote shall be for the quantities mentioned in enquiry and shall be from the latest batch of production with date code Jan 2023 onwards .		
	8	Validity: Quotations should be valid for a period of 180 days from the due date of tender. Once quotation is accepted and order is confirmed, the price must remain same till the completion of the order.		
	9	Your quoted terms of price shall be all inclusive F.O.R ITI Ltd, Dooravaninagar, Bangalore-560016.		
	10	Inspection of goods at our work is final. Goods rejected will be returned on freight to pay basis. Packing & forwarding charges in respect of such consignment will be debited to your account		
	11	We reserve the right to accept or reject any or all offers and order part or full quantity, without assigning any reason		
The bids will be opened on 29.09.2025,10-00AM, Quotations must be submitted through mail, super scribed with our RFQ/tender number & due date and should reach us well before due date & time. Delayed/or late tenders and tenders without tender enquiry number and due date on the cover are liable for rejection without assigning any reason.The bids with no make and part number will not be considered for evaluation.				
For ITI Limited				
DGM-IMM				

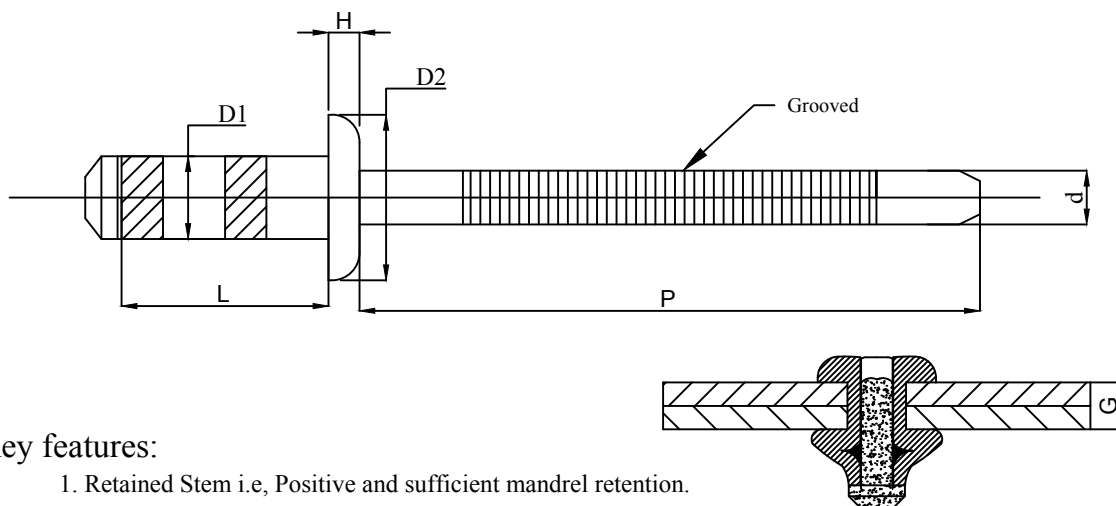

Key features:

1. Retained Stem i.e, Positive and sufficient mandrel retention.
2. High Clamp-up, Rigid clamping, completed formation after riveting.
3. Large blind side bearing area / foot print.
4. For use in heavy duty applications.
5. Riveting by using standard riveting gun.

1. SPECIFICATIONS

Detail	Rivet Dia (D1)	Length(L)	Grip Range(G)	Domed Head Dia(D2)	Head Height(H)	Mandrel Dia(d)	Mandrel length(P)	Drill Dia
1	4.0	10 ± 1	3.0 - 5.0	8 ± 1	1.5 ± 0.2	2.6 ± 0.2	30 ± 5	4.2 ± 0.1

2. MECHANICAL PROPERTIES

Property	Requirement(min)
	D1= 4.0 mm
Tensile Strength	2 .00 KN
Shear strength	2 .00 KN

3. MATERIAL USED

	BODY	MANDREL
MATERIAL	STEEL	STEEL
FINISH	ZINC PLATED	ZINC PLATED

Make and part no. shall be as below,

MAKE	PART CODE FOR DET.1	PART CODE FOR DET.2	PART CODE FOR DET.3
AVDEL(STANLEY)	0BN01-00512 (AVIBULB)	0BN01-00614 (AVIBULB)	0BN01-00618 (AVIBULB)
AVLOCK	HBS44-14010GG (HYDRABULB)	HBS44-14811GG (HYDRABULB)	HBS44-14814GG (HYDRABULB)
GEOBEL	SBS-0512-GB (GO-BULB) (Semistructural Blind Rivet)	SBS-0614-GB (GO-BULB) (Semistructural Blind Rivet)	SBS-0618-GB (GO-BULB) (Semistructural Blind Rivet)
TITONAX RIVELIT	E MH TP ACAC 4012 (Riv-Elit) (High Strength steel Breakstem Rivet)	E MH TP ACAC 4814 (Riv-Elit) (High Strength steel Breakstem Rivet)	E MH TP ACAC 4817 (Riv-Elit) (High Strength steel Breakstem Rivet)
PATTA	HK-LOK,High Strength Blind Rivet, Steel/Steel Dome Head, size 4.0X10mm(L), Grip range 3.0-5.0mm	HK-LOK,High Strength Blind Rivet, Steel/Steel Dome Head, size 4.8X12mm(L), Grip range 3.5-6.0mm	HK-LOK,High Strength Blind Rivet, Steel/Steel Dome Head, size 4.8X14.5mm(L), Grip range 6.0-8.5mm

ALL DIMENSIONS
ARE IN 'mm'TOLERANCES TO
RULING NO. 16

ASCON 42U Rack.

Note:

1. Vendor shall ensure offer,supply as per above Make & part nos.
2. Sample to be submitted along with catalogue,technical data sheet for approval during enquiry stage,before bulk procurement stage.
3. In case of order, NABL certificate to be provided for Tensile and Shear strength.

Semistructural Dome head Blind Bulb Rivet ,
Steel-Znplated(Body)-Steel-ZnPlated(Mandrel)-
Size 4 X 10 Grip range 3 to 5 mm

DRN

TRD.

CHKD

APP.

DD6D6000005NSA2

ITI LIMITED
BANGALORE-16

A4

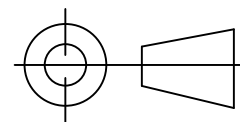

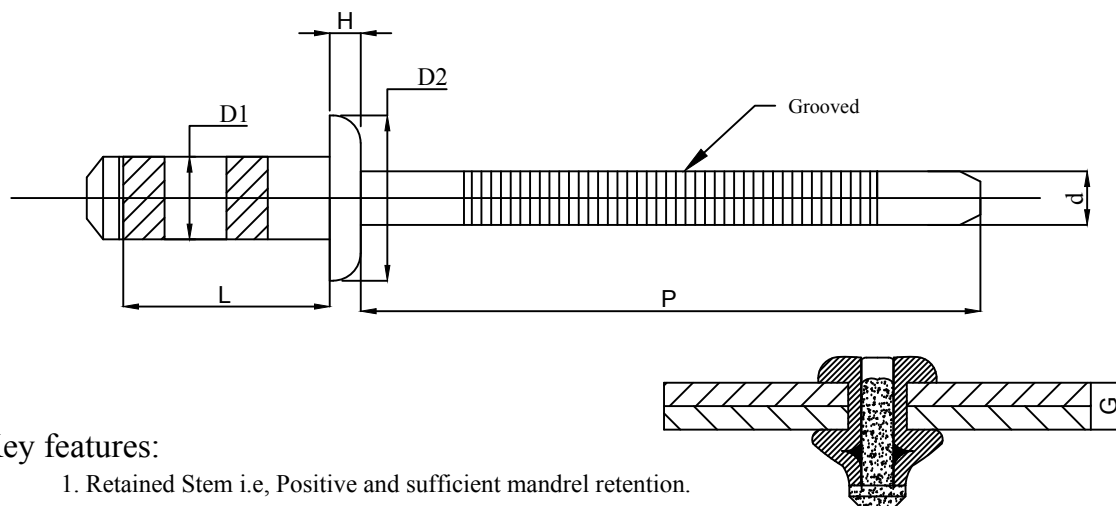
**Key features:**

1. Retained Stem i.e, Positive and sufficient mandrel retention.
2. High Clamp-up, Rigid clamping, completed formation after riveting.
3. Large blind side bearing area / foot print.
4. For use in heavy duty applications.
5. Riveting by using standard riveting gun.

1. SPECIFICATIONS

Detail	Rivet Dia (D1)	Length(L)	Grip Range(G)	Domed Head Dia(D2)	Head Height(H)	Mandrel Dia(d)	Mandrel length(P)	Drill Dia
1	4.8	14 ± 1	6.0 - 8.5	9.6 ± 1	1.5 ± 0.2	3.2 ± 0.2	30 ± 5	5.0 ± 0.1

2. MECHANICAL PROPERTIES

Property	Requirement(min)
	D1= 4.8mm
Tensile Strength	3.00 KN
Shear strength	3.00 KN

3. MATERIAL USED

	BODY	MANDREL
MATERIAL	STEEL	STEEL
FINISH	ZINC PLATED	ZINC PLATED

Make and part no. shall be as below,

MAKE	PART CODE FOR DET.1	PART CODE FOR DET.2	PART CODE FOR DET.3
AVDEL(STANLEY)	0BN01-00512 (AVIBULB)	0BN01-00614 (AVIBULB)	0BN01-00618 (AVIBULB)
AVLOCK	HBS44-14010GG (HYDRABULB)	HBS44-14811GG (HYDRABULB)	HBS44-14814GG (HYDRABULB)
GEABEL	SBS-0512-GB (GO-BULB) (Semistructural Blind Rivet)	SBS-0614-GB (GO-BULB) (Semistructural Blind Rivet)	SBS-0618-GB (GO-BULB) (Semistructural Blind Rivet)
TITONAX RIVELIT	E MH TP ACAC 4012 (Riv-Elit) (High Strength steel Breakstem Rivet)	E MH TP ACAC 4814 (Riv-Elit) (High Strength steel Breakstem Rivet)	E MH TP ACAC 4817 (Riv-Elit) (High Strength steel Breakstem Rivet)
PATTA	HK-LOK,High Strength Blind Rivet, Steel/Steel Dome Head, size 4.0X10mm(L), Grip range 3.0-5.0mm	HK-LOK,High Strength Blind Rivet, Steel/Steel Dome Head, size 4.8X12mm(L), Grip range 3.5-6.0mm	HK-LOK,High Strength Blind Rivet, Steel/Steel Dome Head, size 4.8X14.5mm(L), Grip range 6.0-8.5mm

ALL DIMENSIONS
ARE IN 'mm'

TOLERANCES TO
RULING NO. 16

ASCON 42U Rack.

Note:

1. Vendor shall ensure offer,supply as per above Make & part nos.
2. Sample to be submitted along with catalogue,technical data sheet for approval during enquiry stage,before bulk procurement stage.
3. In case of order, NABL certificate to be provided for Tensile and Shear strength.

Semi Structural Dome head Blind Bulb Rivet ,
Steel-Znplated(Body)-Steel-ZnPlated(Mandrel)-
Size 4.8 X 14 Grip range 6 to 8.5mm

DRN			
TRD.			
CHKD		APP.	

DD6D6000007NSA2

ITI LIMITED
BANGALORE-16

A4

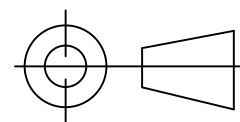

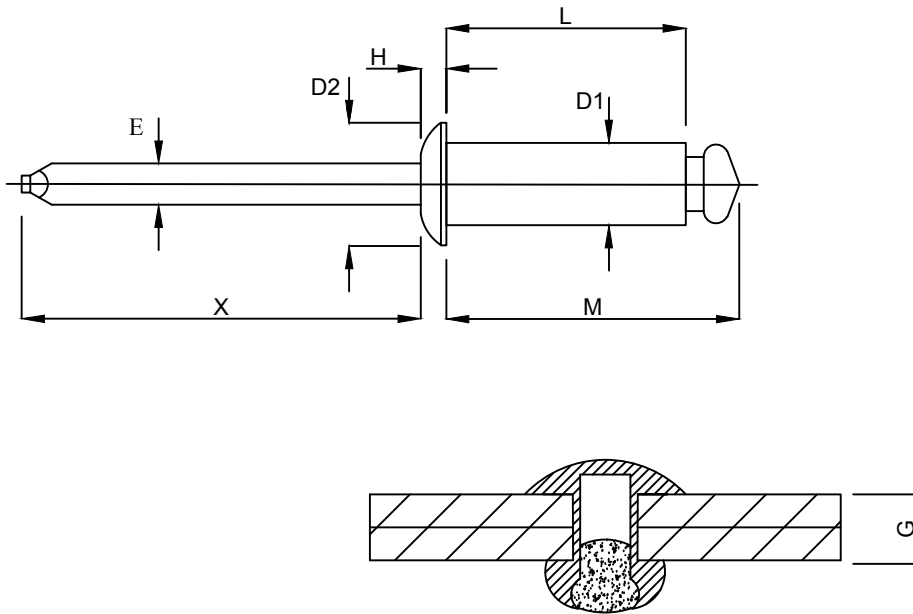

MATERIAL USED		
	BODY	MANDREL
MATERIAL	STEEL	STEEL
FINISH	ZINC PLATED	ZINC PLATED

SPECIFICATIONS									
Detail	Rivet Dia (D1)	Length (L)	Grip Range (G)	M	Dome Head Dia (D2)	Head Height (H)	Mandrel Dia (E)	Length of Mandrel (X)	Drill Dia
1	3.2	8 ± 1	1.5-3.2	$L+D1 \text{ min}$	5.2 ± 0.5	0.9 ± 0.3	1.5 ± 0.5	30 ± 5	3.3 ± 0.05

ALL DIMENSIONS ARE IN 'mm'

TOLERANCES TO RULING NO. 16

ASCON 42U Rack.

Note: Sample to be submitted along with catalogue/technical data sheet for approval during enquiry stage / before bulk procurement stage.

Pop Rivet
Steel-Znplated(Body)-Steel-ZnPlated(Mandrel)-
Size 3.2 X 8 Grip range 1.5 to 3.2mm

DRN			
TRD.			
CHKD		APP.	

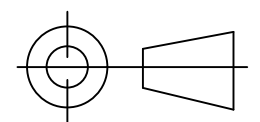

DD6D6000009NSA2

ITI LIMITED
BANGALORE-16

A4

SHEET:-1 OF 2		
ISSUE		
	DATE	MR
01	13-08-2024	

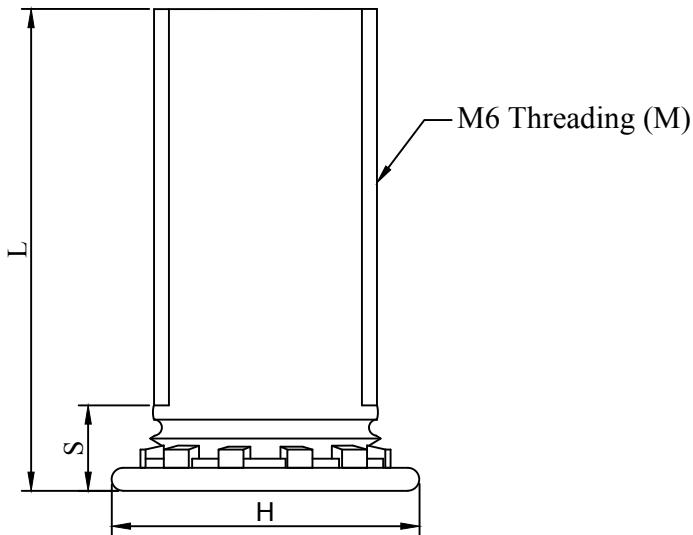
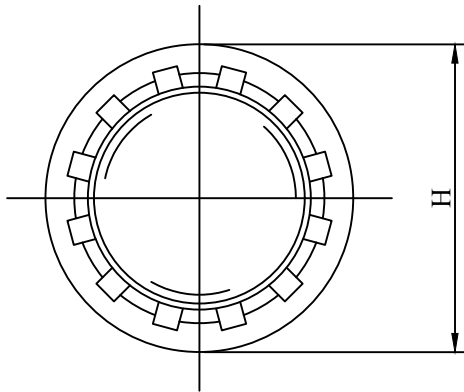

DET.1

Note:
 1.Sample to be submitted along with catalogue/technical data sheet for approval during enquiry stage , before bulk procurement stage.

ALL DIMENSIONS ARE IN 'mm'

TOLERANCES TO RULING NO. 16

REF: ASCON 42U RACK

1	M6	20±0.4	3	8.2 ±0.4	6 ^{+0.08} _{-0.0}	1.6mm	SS 304	
DET.NO.	Threading (M)	L	S	H	Hole Size in sheet	Sheet thk	Material	FIN.

W.O:

U.O:

M6x20 SS self Clinch stud for 1.6mm sheet

DRN			
TRD.			
CHKD		APP.	

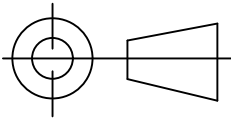

DD6C9010003NSNS

ITI LIMITED
BANGALORE-16

A4